

J E T

JPF-2

Power feeder

**10000256M
230/50/1**

PARTS LIST

Walter Meier (Tool) AG

Tämperlistrasse 5

CH-8117 Fällanden

Switzerland

Phone +41 44 806 47 48

Fax +41 44 806 47 58

jetinfo.eu@waltermeier.com

www.jettools.com



P-10000256M 2010/06/25

JPF-2 Partlist and breakdown, 28.10.2003

Part No.	Code No.	Description	Q'ty		Part No.	Code No.	Description	Q'ty
47B	47B	Base Kit			49B-5*	S13-1050	Screw	1
47B-1	A20-0324-4	Base	1		87A	U01-1305	Wheel Handle	1
47B-2	R11-0250	Washer	1		91B	G41-0313	Elevating Shaft Kit	1
47B-3	G41-1312	Lever	1		92B	G41-0314	Overarm Cone	1
47B-4*	N13-008R	Nut	1		94B	G41-1310	Elevating Screw	1
48B	48B	Elevating Bracket Kit			95B	G41-1309	Pinion Kit	1
48B-1	A20-0331-5	Elevating Bracket	1		96B	96B	Column Cape Kit	
48B-2	R11-0250	Washer	2		96B-1	C02-0323A	Column Cape	1
48B-3	G41-1312	Lever	2		96B-3*	S33-0812	Screw	3
48B-4	N13-008R	Nut	4		97B	97B	Handwheel Kit	
48B-5	S33-0820	Screw	2		97B-1	C02-1301-3	Handwheel	1
48B-6*	R12-0008	Spring Washer	2		97B-2*	P21-0430	Pinion	1
49B	49B	Overarm Cone Kit			99B	99B	Swivel Cone Kit	
49B-1	A20-0325-4	Overarm Cone	1		99B-1	A20-0321-4	Swivel Cone	1
49B-2	N14-016R	Nut	1		99B-2	N14-016R	Nut	1
49B-3	G41-1311	Lever	1		99B-3*	G41-1311	Lever	1
49B-4	R11-0300	Washer	1					

*. Specifications subject to change without prior notice.

JPF-2

(US/11) LIGHT-DUTY UNIVERSAL STAND

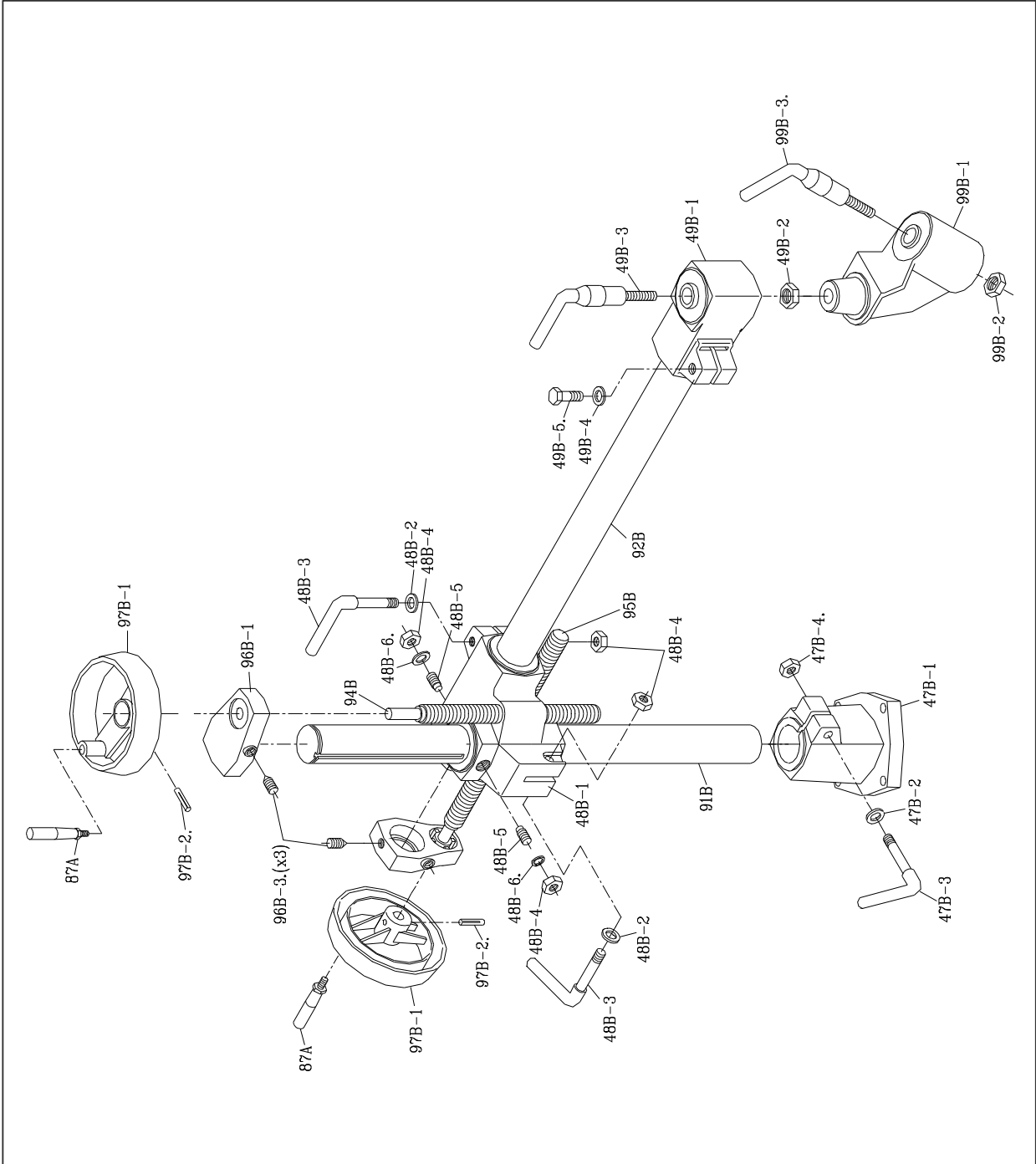

JPF-2

Part No.	Code No.	Description	Q'ty	Part No.	Code No.	Description	Q'ty	Part No.	Code No.	Description	Q'ty	Part No.	Code No.	Description	Q'ty
21A	21A	Oil Cap Kit		70B-1	H45-0350A	Sprocket Shaft	1	80B	80B	Worm Gear Box Cover Kit					
21A-1	U01-0308	Oil Cap	1	70B-2	R11-0300	Snap Ring	1	80B-1	Q04-0303	Oil Seal	1				
21A-2*	Q01-0015	"O" Ring	1	70B-3*	N13-010R	Nut(M10)	1	80B-2	A50-0302	Bushing	1				
65B	65B	Sprocket Case Kit		71B	71B	Sprocket Shaft Kit		80B-3	C02-0322	Worm Gear Cover	1				
65B-1	C02-0331-1	Sprocket Case	1	71B-1	U01-1307	Grease Nipple	1	80B-4	Q03-0302	Oil Seal	1				
65B-2	U01-0366	Spring	1	71B-2	H45-1318	Shaft	1	80B-5*	S23-0512	Screw(M5x12L)	4				
65B-3*	U01-0354	Case Cover	1	71B-3	R12-0008	Spring Washer	1	81B	81B	Gear Kit – 20T, 30T					
66B	66B	Sprocket Kit		71B-4*	N13-008R	Nut(M8)	1	81B-1	A50-0327	Gear (30T)	1				
66B-1	C02-0334A	Roller Supporter	1	75B	75B	Frame Kit	1	81B-2*	A50-0324	Gear (20T)	1				
66B-2	A50-0336	Sprocket	1	75B-1	C02-0321-3	Frame	1	82B	82B	Gear Kit – 24T, 26T					
66B-3	R21-0022	Snap Ring	1	75B-2*	A50-0306	Bushing	1	82B-1	A50-0323	Gear (26T)	1				
66B-4	R13-0200	Spring Washer	2	77B	77B	Transmission Kit	2	82B-2*	A50-0326	Gear (24T)	1				
66B-5*	S23-0625	Screw(M6x25L)	2	77B-1	A50-0303	Sprocket	2	83B	Q02-0060	"O" Ring	1				
67B	L20-0318	Chain Kit (18S)	3	77B-2	A50-0307	Sprocket	2	85B1	85B1	Motor 1/4 Hp (Single phase)					
68B	68B	Tube Kit		77B-3	A50-0308	Bushing	1	85B3	85B3	Motor 1/4/HP (3 Phase)					
68B-1	A50-0331-2	Tube	1	77B-4	L20-0330	Chain (30S)	1	86B	86B	Switch Box Kit					
68B-2*	R21-0026	Snap Ring	1	77B-5*	L20-0322	Chain (22S)	1	87B	J01-0368	Switch Kit	1				
69B	69B	Sprocket Shaft Kit		79B	79B	Worm Gear Shaft Kit		96A	U01-0370	Back Cover	1				
69B-1	H45-0351A	Sprocket Shaft	1	79B-1	H45-0348	Worm Gear Shaft	1	97A	U01-0351	Knob	1				
69B-2*	R21-0015	Snap Ring	1	79B-2	R11-0300	Washer	1	RO-08	C02-0302-3	Roller (30 x 80 Dia)	3				
70B	70B	Sprocket Kit		79B-3*	N13-010R	Nut(M10)	1								

JPF-2 HOUSING ASSEMBLY

